

Model NPS19

Piezoresistive OEM pressure sensor
Mass production, automated calibration

Features

- ▣ Piezoresistive pressure chip encapsulated in an oil-filled metal housing
- ▣ Measuring ranges from 100mbar to 1000bar
- ▣ Gauge pressure, absolute pressure
- ▣ Accuracy: $\pm 0.25\%FSO$ (Typ.)
- ▣ $\varnothing 19\text{mm} \times 14\text{mm}$



Application

- ▣ Hydraulic and pneumatic
- ▣ OEM
- ▣ Laboratory
- ▣ Water treatment
- ▣ IoT pressure measurement

Technical data

Performance		
Accuracy*	$\pm 0.25\%FS$ (typ.), $\pm 0.5\%FS$ (max.)	*Linearity (best straight line) + Hysteresis + Repeatability
Linearity	$\pm 0.2\%FS$ (typ.), $\pm 0.3\%FS$ (max.)	
Hysteresis	$\pm 0.03\%FS$ (typ.), $\pm 0.05\%FS$ (max.)	
Repeatability	$\pm 0.03\%FS$ (typ.), $\pm 0.05\%FS$ (max.)	
Operating temperature	-40 to 125°C	
Compensated temperature range	0 to 60 °C(P \leq 0.35 bar), -10 to 70 °C(P>0.35 bar)	
Temperature coefficient zero	$\pm 0.75\%FS$ (typ.), $\pm 1.5\%FS$ (max.)	* (Pressure >0.1 bar)
Temperature coefficient sensitivity	$\pm 0.75\%FS$ (typ.), $\pm 1.5\%FS$ (max.)	
Vibration	10 g RMS(20 to 2000Hz)	
Shock	100 g(10ms)	
Cycles	10×10^6	
Overpressure	150 %FS(P \leq 400bar), 120 %FS(P>400 bar)	
Long term stability	$\pm 0.2\%FS$ (typ.)	

Electrical @25°C	
Zero output	$\pm 2\text{ mV} / V_S = 1.5\text{ mA}$
Full scale output	70 mV(typ.) , 150 mV(max.) / $V_S = 1.5\text{ mA}$
Excitation	1 mA~2 mA
Bridge resistance	2~8 k Ω
Insulation resistance	100 M Ω @100VDC

Physical Specifications	
Housing	316L stainless steel
Diaphragm	316L stainless steel
Oil Filling	Silicone oil
Weight	~20g

The listed specifications and dimensions are subject to change without prior notice

Model NPS19

Piezoresistive OEM pressure sensor
Mass production, automated calibration

VOLLTEL
Sensing and Internet of Things

Standard pressure range

Code	Nominal pressure [bar]	Gauge	Sealed gauge	Absolute
01	0...0.1	✓		
02	0...0.2	✓		
03	0...0.35	✓		✓
04	0...0.7	✓		✓
05	0...1	✓		✓
06	0...1.6	✓		✓
07	0...2.5	✓		✓
08	0...4	✓		✓
09	0...6	✓		✓
10	0...10	✓		✓
11	0...16	✓	✓	✓
12	0...25	✓	✓	✓
13	0...40		✓	
14	0...60		✓	
15	0...100		✓	
16	0...160		✓	
17	0...250		✓	
18	0...400		✓	

Code	Nominal pressure [bar]	Gauge	Sealed gauge	Absolute
19	0...600		✓	
20	0...1000		✓	
21	-0.1...+0.1	✓		
22	-0.2...+0.2	✓		
23	-0.5...+0.5	✓		
24	-1...0	✓		
25	0...-1	✓		
26	-1...+1	✓		
27	-1...+1.6	✓		
28	-1...+2.5	✓		
29	-1...+4	✓		
30	-1...+6	✓		
31	-1...+9	✓		
32	-1...+10	✓		
33	-1...+16	✓		
34	-1...+25	✓		
35	0.8...2	✓		✓

Dimensions (All dimensions in mm)

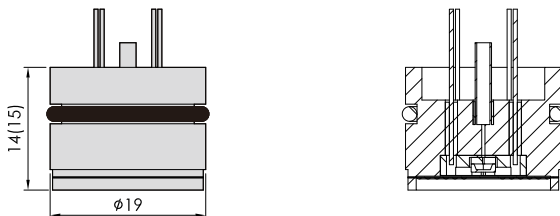

Ordering code

Model	Range	Type	Output / Excitation	Electrical Connection	Compensation
NPS19	code	G gauge	A mV / 1.5 mA	F silicon rubber wires(L=100mm)	T with temperature compensated
		S sealed gauge	B mV / DC 10V	P pins	N without temperature compensated
		A absolute	C I ² C / 3.3~5VDC		
			D 0.5~4.5VDC / 5VDC		
			E 4~20mA / 10~30VDC		